



home owner
information



simple
effective
tested
proven



Altis 
TERMITE RETICULATION SYSTEM

WHAT IS ALTIS

Altis is a unique patented chemical delivery system which uses reticulation principles to deter termite attack to buildings.

WHEN IT IS INSTALLED

It is installed under concrete slabs prior to construction and around the exterior to provide a complete and continuous chemical barrier when charged with a registered liquid chemical.

THE EMITTER

The emitter is the delivery mechanism for the system, it is also a back flow preventer and stops grit and roots entering the pipe. What this means is that Altis delivers liquid chemical at a precise rate evenly throughout the entire system.



Another unique aspect of the emitter is the "typhoon effect". This effect is the creation of turbulence in the emitter which enables the liquid chemical to be drawn through the emitter at a higher rate of flow than through the pipe itself.

*Emitters are located each 200mm and are designed to deliver the liquid chemical at a rate of 2.6 Litres per Hour.



emitter flow showing typhoon effect

THE ALTIS RETICULATION SYSTEM

Why Altis is the Reticulation System

- Most structures require only one chemical injection point allowing the system to be more cost effective and less obtrusive to your property.
- Has scientifically designed and regulated delivery points (emitters) which ensure the correct amount of chemical is delivered to all areas being treated.
- Achieves remarkable accuracy in delivery of chemicals.
- Can be used on sites where there is a 5 metre height difference between chemical injection point and other sections of the site.
- Has an engineers report confirming that Altis operates effectively in clay even if clay subsidence occurs.
- Brightly coloured purple pipe distinguishes the system from the other materials on site. The colour is trademarked.
- Installation can be checked by calculating the system, to ensure it's operating as designed.
- Can be installed in new and existing buildings.

simple
effective
tested
proven

WHAT IS DIFFERENT ABOUT ALTIS

The Altis pipe is uniquely different. There are no holes. The liquid chemical is dispersed at a very low pressure through a scientifically designed unit called an emitter which is moulded into the pipe at the time of manufacture.



SAFETY

The revolutionary Altis System is an environmentally friendly way to apply chemicals beneath or around the outside of your building.

Advantages include:

- Applied at the label rate only; no under or over treatment.
- No spray drift which may endanger workers, occupants or pets.
- The injection process allows for re-application of termiticide at any time in the future. As new improved chemicals become available, retreating can take advantage of the latest advances.
- Currently available newer chemicals are completely safe to humans and other mammals.

PROVEN

The Altis System has been protecting homes, extensions, and commercial buildings such as offices and hospitals since 1995. Should a breach occur, recharging the system would retreat the affected area and eradicate the problem.

Altis Systems are installed by Altis trained and accredited persons. The Pest Management firm that is licensed to install Altis is responsible for the installation and that the chemicals are being used according to the chemical manufacturer's label.

PROTECTING AUSTRALIAN HOMES SINCE 1995



50 YEAR PROTECTION & REPLENISHABLE



SYSTEMS AVAILABLE

Your accredited Altis installer can advise you on what best suits your situation.

- ① FULL UNDERSLAB
- ② INTERNAL PERIMETER
- ③ EXTERNAL PERIMETER
- ④ EXISTING BUILDING
- ⑤ EXTENSION
- ⑥ NEW BUILDING



SYSTEMS AVAILABLE

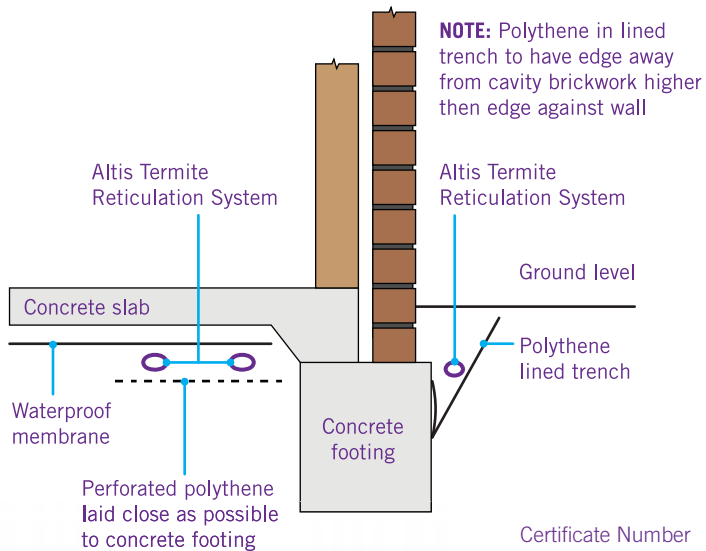

Certificate Number
SAIG-07-CM20007

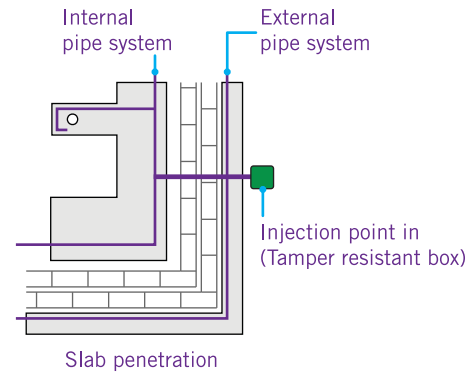
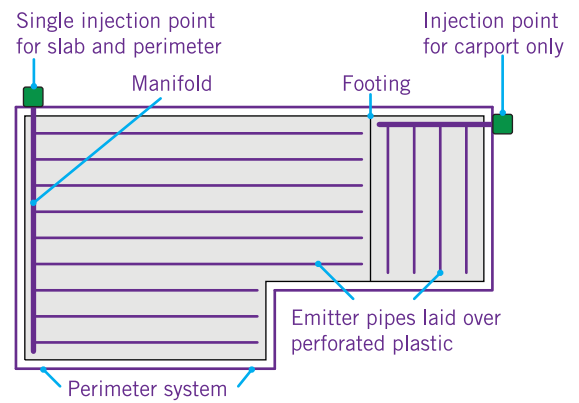

COMPLIANCE (CODEMARK)

We have a CodeMark certificate of conformity which meets or exceeds Building Code of Australia requirements. It is a quality system.

The CodeMark certificate can be sighted on www.altis.net.au. CodeMark is only available for products and systems which last 50 years or more and which meet rigid quality standards. This means that Altis is approved for use in new construction. Many other reticulation products are not.

CHEMICAL APPLICATION

Chemical application rates are in accordance with each label approved by the Australian Pesticides and Veterinary Medicines Authority (APVMA). Chemicals approved by APVMA can be applied via the Altis system. Examples of approved chemicals include Biflex, Termidor and Premise.

The chemical injection point is secured in a tamper resistant box located at a convenient position outside the building. The lid or top of the box may be positioned flush with natural ground level or top of paving.

A non-return valve is used when injecting chemical into the Reticulation System.

A complete record of chemical type and application rates, date of treatment

and inspection are maintained by the licensed installer.

WARRANTY PROTECTION

Altis will warrant the component parts of the system in accordance with the APVMA registered label of the chemical used, which could range between 5 years to 10 years or more depending on brand and type of chemical used and site and climatic conditions. The warranty is subject to an annual inspection and maintenance as recommended by Australian Standard AS 3660.1-2000. It must be carried out by an Altis accredited and trained installer.

ANNUAL INSPECTIONS

The Australian Standard 3660.1-2000 recommends that maintenance be carried out within 3 months of completion of the building and then not less than each twelve months. The primary purpose of the yearly inspection is to ensure breaches of the chemical barrier have not occurred. As part of the yearly maintenance Altis licensed installers can offer the retreatment of the external system on a more regular basis to ensure peace of mind. The service will be less expensive and less intrusive than a drill and inject treatment.

CONTACT US

T: 07 3349 9274
F: 07 3849 7980
E: info@altis.net.au
PO Box 961, Sunnybank
Queensland. 4109

www.altis.net.au

50 YEAR PROTECTION & REPLENISHABLE